

# Sellstrom® ArcFlash™ Faceshield

## Installation, Operation & Maintenance Manual

Instruction: INST-ARCF

Effective: 6/2014

Expires: 6/2022

Replaces: 6/2012

Thank you for purchasing the Sellstrom® ArcFlash™ Faceshield. This product was designed to protect the user from low level arc flash hazards. The specially formulated window provides excellent color definition and an arc rating of 9.9Cal/cm<sup>2</sup>. Meets ANSI Z87.1+, ASTM F-2178-08 and NFPA 70E Standards.



### WARNING!

#### Under Penalty of Law:

These instructions are not to be removed except by the user of this equipment. Current instructions must always be available to any potential user. Note: Because of continuous developments in the application and use of Sellstrom equipment and our desire to serve your best interests, these instructions are invalid 10 years after the effective date on these instructions. If you purchase a product, and these instructions are out of date, call Sellstrom Customer Service and request current instructions. Dial toll free (800) 323-7402 (U.S. and Canada) or (847) 358-2000.

If you have difficulty or experience any problem with Sellstrom equipment or the instructions, call the above toll-free number or (847) 358-2000 immediately and ask the Customer Service department for assistance.

You must read and fully understand or have the following instructions explained to you before using this equipment. Failure to do so could result in serious or fatal injury.

Atencion: Si usted no puede leer el ingles o si usted no comprende estas instrucciones, favor de consultar su director de seguridad o su supervisor. De lo contrario se pueden producir lesiones graves o fatales.

**READ ALL SAFETY AND WARNING INSTRUCTIONS CAREFULLY before attempting to install, operate or service your faceshield. Consult with a qualified instructor or supervisor if you have questions. Your failure to comply with the instructions could result in personal injury and/or property damage.**

**sellstrom**  
Product that works.

300 Corporate Drive  
Elgin, IL 60123  
Phone: (800) 323-7402  
Fax: (847) 717-8419  
www.sellstrom.com

## 1.0 Window & Chin Guard Removal

### 1.1 Window Removal:

- 1.1.1 Turn window retaining clip to a horizontal position. See Image 1 & 2.
- 1.1.2 Remove window from all retaining clips.
- 1.1.3 Pull window down and out of crown. See Image 3.

### 1.2 Chin Guard Removal:

- 1.2.1 Disengage window from the three retaining studs located at the bottom inside portion of the faceshield. Start at either corner, using your thumb; push the corner of chin guard off the window, then apply pressure to the lower front of the window to pop the window off the retaining studs. See Image 4.
- 1.2.2 Pull chin guard down to remove from window. See Image 5.

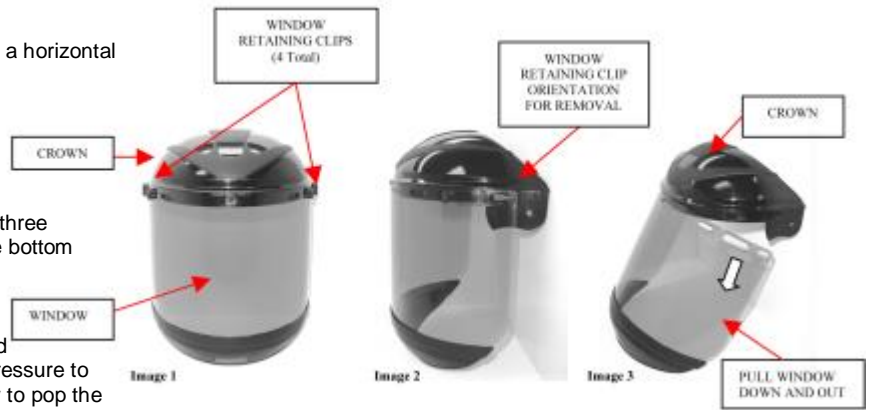

## 2.0 Window & Chin Guard Installation

### 2.1 Window Installation:

- 2.1.1 Insert window behind two front retaining tabs and then lift window to crown. See Image 6.
- 2.1.2 Install window by placing window over retaining clips and turning clips down into a vertical position. See Image 7.

### 2.2 Chin Guard Installation:

- 2.2.1 Insert the bottom corners of the window into the chin guard. See Image 8.
- 2.2.2 Align holes in window with retaining studs on chin guard, then push window into chin guard. All three remaining studs will snap in place. See Image 9.

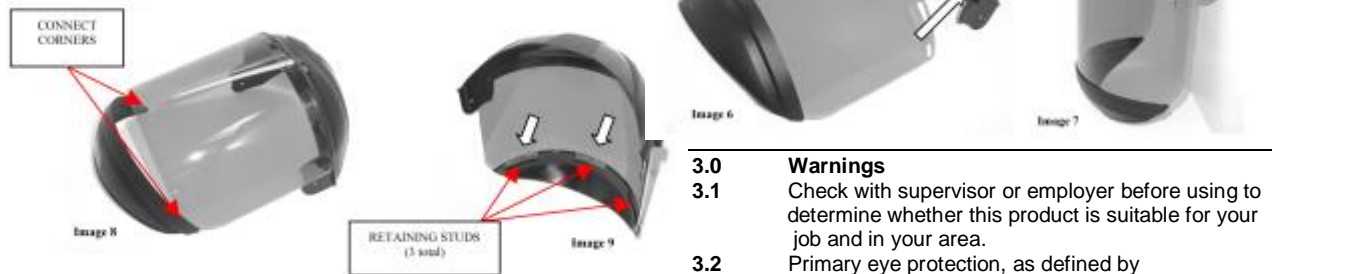

## 3.0 Warnings

- 3.1 Check with supervisor or employer before using to determine whether this product is suitable for your job and in your area.
- 3.2 Primary eye protection, as defined by ANSI Z87.1+ must be worn whenever using this product. To determine which eye protective device should be used with this faceshield window under specific circumstances, you should consult with your supervisor or employer.
- 3.3 Impact resistant shields are NOT unbreakable and DO NOT provide extraordinary protection against flying particles, splash, spray, and spatter. They will not provide protection against severe impact hazard, such as, but not limited to, fragmenting grinding wheels, high speed projectiles, explosive devices or molten metal.
- 3.4 Pitted, scratched or worn faceshield window reduces vision clarity, SEVERELY REDUCES PROTECTION, and should be replaced immediately.
- 3.5 This product is NOT suitable for protection against x-rays, gamma rays, high energy particulate radiation, lasers, and/or masers.
- 3.6 Inspect the faceshield window frequently and immediately replace worn, pitted, or scratched window.
- 3.7 The chin protector is a required component for arc flash protection. DO NOT REMOVE.
- 3.8 This faceshield window **DOES NOT** provide any protection against infrared or ultraviolet radiation.
- 3.9 **DO NOT USE FOR ARC WELDING!**
- 3.10 This product does NOT conform to ANSI Z87. 1+ for welding helmets.
- 3.11 You should give this caution to any user of this product.

## 4.0 Questions?

If you have any questions about these instructions or about the proper use of any Sellstrom equipment, call Sellstrom Toll Free 1-800-323-7402. Our customer Service Department is available to answer your questions. If you would like additional explanation or if you experience any problems with Sellstrom equipment, please contact us immediately for assistance.